

DIMENSIONS & ACCESSORIES

CLASSIC DIN RAIL

TYPES: YRxx

CLASSIC PLUG IN

TYPES: 8Rxx & 11Rxx

MODULAR DIN RAIL

TYPES: UNI-xxx

Classic DIN rail: Maximum cable size 4mm²
 Modular DIN rail: Maximum cable size 2.5mm²

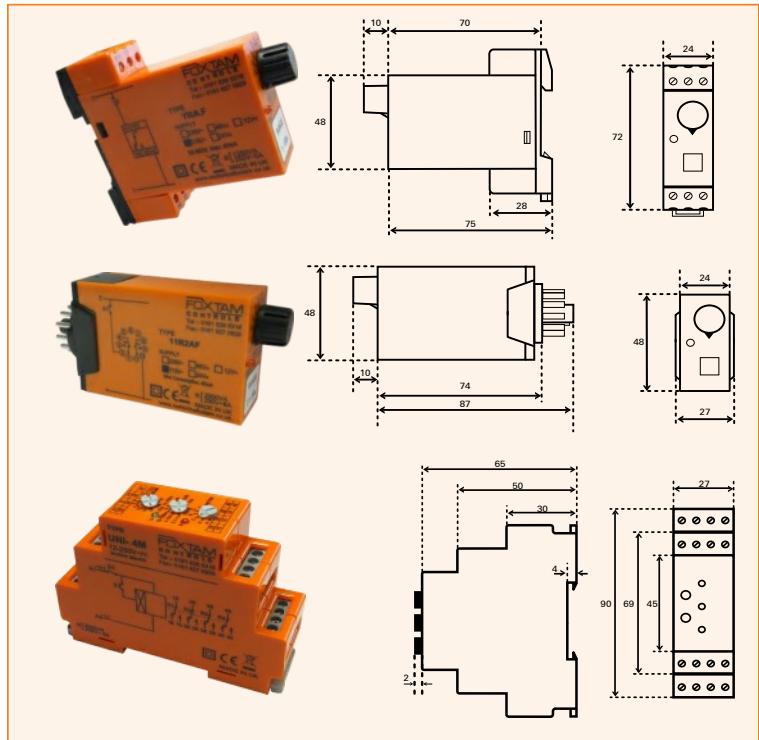

PANEL MOUNTING ADAPTOR - P

Material: Auto-extinguishable poly-carbonate
 Colour: Black

- Mounting by M4 screws to DIN 46121
- Timer is mounted by clipping on

PRODUCT GROUP
A

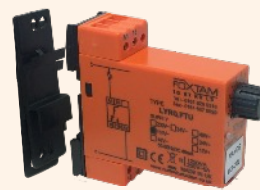

PANEL MOUNTING ADAPTOR - P

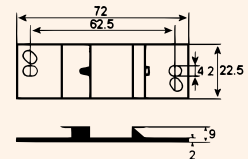

ASYMMETRICAL DIN ADAPTOR - A

Material: Auto-extinguishable poly-carbonate
 Colour: Black

- Timer is mounted by clipping on

PRODUCT GROUP
A



ASYMMETRICAL DIN ADAPTOR - A

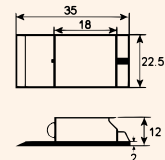

SCREW TERMINAL SOCKET PF-083BE PF-113BE

Material: Auto-extinguishable poly-carbonate
 Colour: Black

- Mounting on a symmetric din or by single M4 Screw and locator

PRODUCT GROUP
H

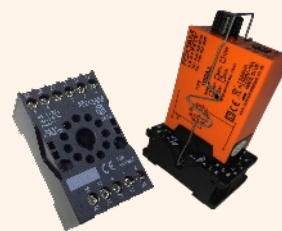

SCREW TERMINAL SOCKET PF-083BE, PF113BE

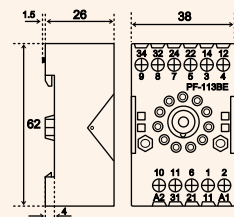

RETAINING SPRINGS

For 8 & 11 Series: NBS

PRODUCT GROUP
A

FREE SOCKET 8 PIN US-08 11 PIN US-11

Material: Auto-extinguishable poly-carbonate
 Colour: Black

- Connection for timers in through panel mounting Adaptor 8/11

PRODUCT GROUP
C



FREE SOCKET - 8 pole US-08 - 11 pole US-11

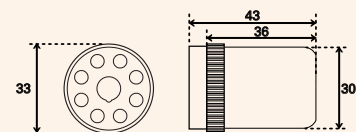

THROUGH PANEL MOUNTING ACCESSORY 8/11 ADAPTOR

Material: Auto-extinguishable ABS
 Colour: Black

- Permits through panel mounting of 8 & 11 pin timers

PRODUCT GROUP
A



THROUGH PANEL MOUNTING ACCESSORY - 8/11

